



MAKE WORK  
LIFE EASIER

# Set-Up Guide

## Arc M Universal System

**INTELLIGENT**  
TORCH SOLUTIONS

# Universal System-Small Housing

Tweco®, Miller®, LPB and LPW Connection



MAKE WORK  
LIFE EASIER

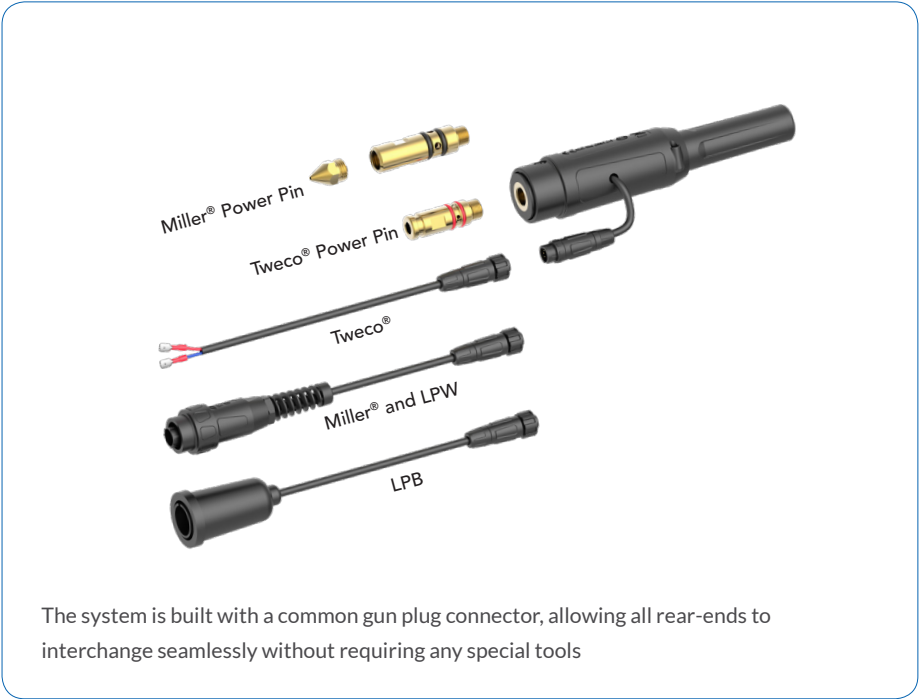

## Uni to Lincoln® Connection

### 1-2

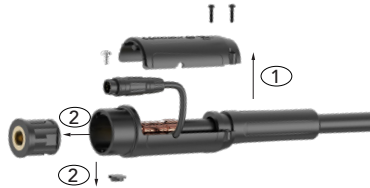

1. Open Rear End Housing
2. Remove Gun Plug Body, and Housing Stopper

### 3-5

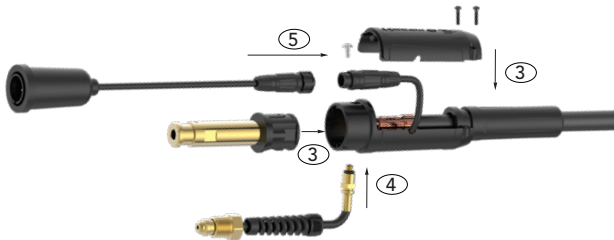

3. Assemble Lincoln® Power Pin Assembly and Housing
4. Assemble Lincoln® Gas Tube Assembly
5. Connect Quick Fit Assembly

### 6



6. Complete Lincoln® Connection

## Uni to Euro® Connection

### 1-2

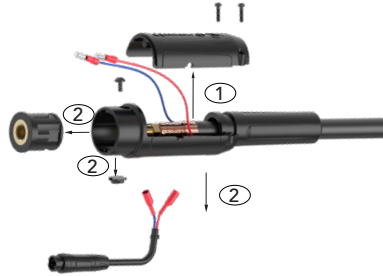

1. Open Rear End Housing
2. Remove Gun Plug Body , Housing Stopper and Male Switch Wire Plug

### 3-5

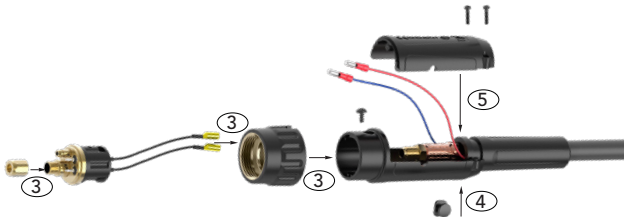

3. Assemble Liner Retaining Nut and Hybrid Gun Plug Body and Gun Plug Nut
4. Assemble Housing Stopper
5. Assemble Housing

### 6



6. Complete Euro® Connection

# Universal System-Large Housing

Tweco®, Miller®, LPB and LPW Connection



MAKE WORK  
LIFE EASIER

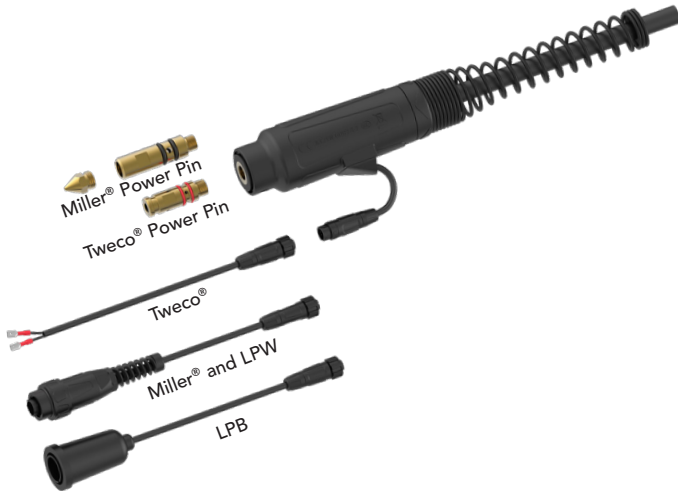

The system is built with a common gun plug connector, allowing all rear-ends to interchange seamlessly without requiring any special tools

## Uni to Lincoln® Connection

### 1-2

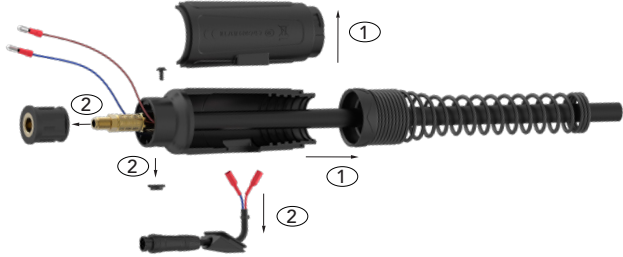

1. Remove Support , open Housing
2. Disassemble Plug Body , Housing Stopper and Male Switch Wire Plug

### 3-5

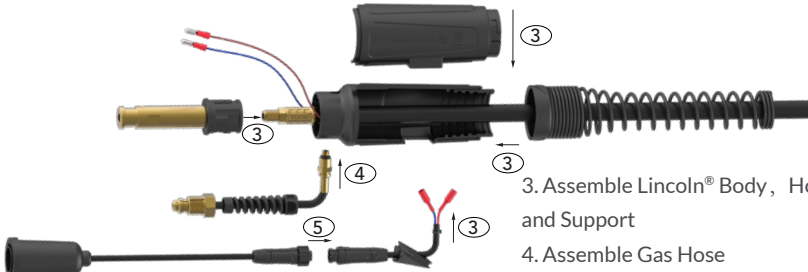

3. Assemble Lincoln® Body , Housing and Support
4. Assemble Gas Hose
5. Connecting switch plug

### 6



6. Complete Lincoln® Connection

## Uni to Euro® Connection

### 1-2

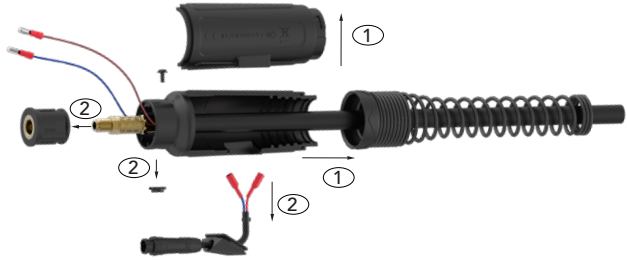

1. Remove Support , open Housing
2. Disassemble Plug Body , Housing Stopper and Male Switch Wire Plug

### 3-5

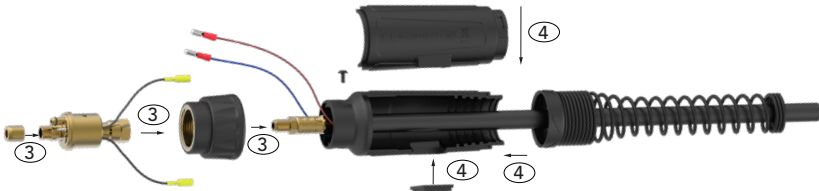

3. Assemble Nut and Euro® Body
4. Assemble Flat cover , Housing and Support

### 6



6. Complete Euro® Connection

ARC SERIES

# Make Work Life Easier

MPA025 / 2024.01



MAKE WORK  
LIFE EASIER